

SJS-SARJA

Paineensäädin

SJS
 SJS-sarja

- Paineensäädin
- 316 ruostumaton teräs
- 0,9 kg



SJS REGULATOR SHOWN WITH THE 42MW WELDED DIAPHRAGM INSTRUMENT ISOLATOR (OPTIONAL)

TUOTEKUVAUS

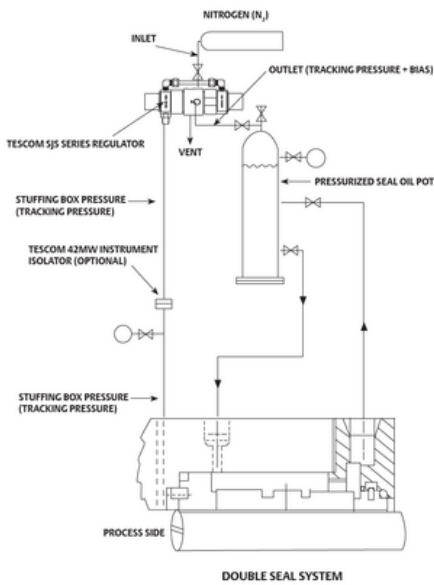

Example for selecting a part number:

SI	S	6	S	V	E	A	O	E	FFF
BASIC SERIES	TYPE	BODY MATERIAL	OUTLET PRESSURE	O-RING MATERIAL	DIAPHRAGM MATERIAL	SEAT MATERIAL	FITTINGS OPTION	PORTING	INLET, VENT, AND OUTLET POST TYPE
SI	S - Screwdown Adjustment	6 - 316 Stainless Steel	S - 500 psig (34.5 bar) Max. Allow. Ref. Pressure	E - Ethylene Propylene Rubber** (EPDM)	E - Cobalt Nickel Alloy (Inconel)	A - Pressure Inducing PTFE Backpressure Plate (Inconel)	O - No Fittings F - Fittings	E - 90° Vent	FFF - 1/4" NPTF

** 1100X, Perfluoropolymer (Kalloy®)

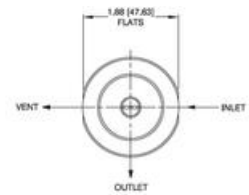

NOTE
 INCLUDED WITH FITTING OPTION

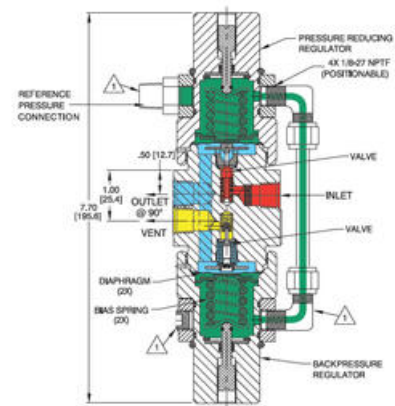

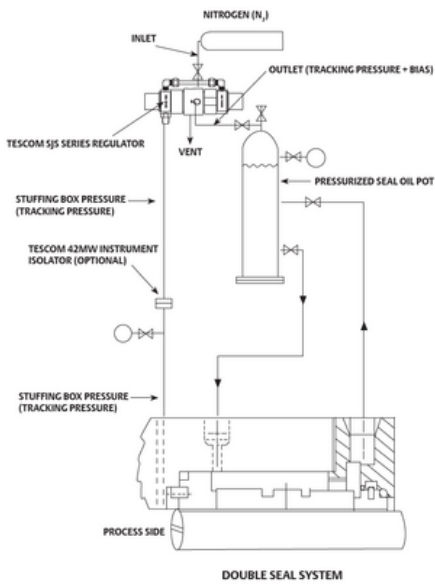

Example for selecting a part number:

SJ	S	G	S	V	E	A	O	E	FFF
BASIC SERIES	TYPE	BODY MATERIAL	ORIFICE PRESSURE	O-RING MATERIAL	DIAPHRAGM MATERIAL	SEAT MATERIAL	FITTINGS OPTION	PORTING	INLET, VENT, AND-OUTLET POLE TYPE
SJ	S - Standard Adjustment	G - 316 Stainless Steel	S - 500 (20) 34.5 bar Max. (20in Hg. Min. (10in Hg.))	V - Ethylene Propylene Rubber (EPR) K - Kalorix® N - NEM (Viton® A)	E - Cobalt Chrome Nickel Alloy (HighPore)	A - Pressure Reducing FRIE B - Pressure Reducing FRIE Backpressure FRIE	O - No fittings F - Fittings	E - 90° Vent FFF - 1/2" NPT	

** EPRM, Polysulfone (Kalorix)

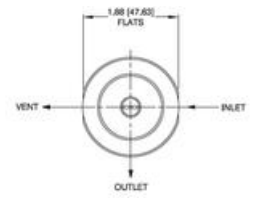

NOTE:
 △ INCLUDED WITH FITTING OPTION

